

2-1 Wiring installation instructions

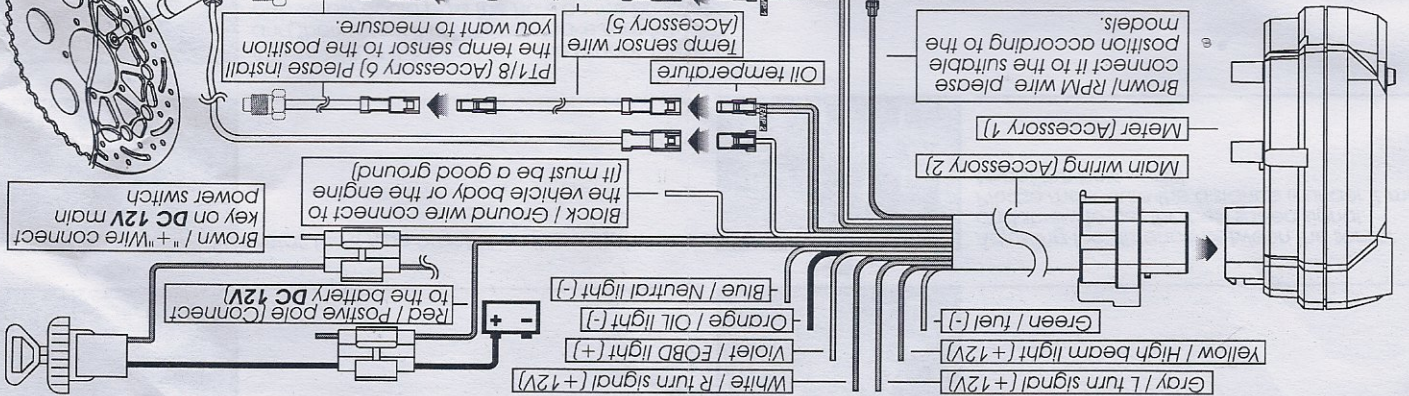

Main switch wiring reference:

Power	Key on
YAMAHA	Red
HONDA	Red / Black
SUZUKI	Black
KAWASAKI	White
KYMCO	Brown
SYM	Red
PGO	Red / White
	Orange
	Black

RPM wiring reference:

YAMAHA	Yellow / Black
BUELL	Pink
HONDA	Yellow / Green
CAGIVA	Gray / Green
SUZUKI	Gray / Blue
KAWASAKI	Light Blue
H-D	Pink
APRILIA	Gray / Violet
BMW	Black
BENELLI	Gray / Violet

NOTE The color listed above may differ depending on the model.

YAMAHA	Green
KYMCO	Yellow / White
HONDA	Yellow / White
SYM	Yellow / White
PGO	Gray
SUZUKI	Yellow / White
KAWASAKI	Black / Green

NOTE The fuel sensor is electronic type, please don't connect it with the original, otherwise the fuel gauge won't display.

NOTE The temperature will disappear if you don't install & connect the temperature sensor with the meter. When connecting the power wiring, please follow the instruction. If you connect the red & brown wiring in parallel will cause the meter work improperly.

- ▲ The RPM wire installation
- A1. Please use tape to fix the RPM (Type A) wire onto the spark plug.
 - A2. Please use tape to fix the RPM wire (Type A) on the spark plug cap.
 - A3. Please use tape to fix the RPM wire (Type A) on the coil positive pole. For some models with the YAMAHA V-max (1200) the RPM wire (Type A) on the negative wire to get the RPM signal. (For example, the YAMAHA V-max 1200)
 - B. Please connect the RPM wire (Type B) to connect to the ignition coil positive pole.
 - C. Please connect the RPM wire (Type A) to the pick up.
 - D. Please parallel the RPM wire (Type A) with the original tachometer signal wire (this method is available only when the original speedometer comes with a tachometer on it. You could get the RPM wire information from the service manual of your bikes.)
 - E. For the models comes with the new ignition coil, please wrap the RPM wire (Type A) at least 5 times around the spark plug as the above drawing.
 - F. Please use the method mentioned above to install the RPM wire, and then connect the ground wire to the frame body or the engine. (Please make sure that the ground is a good ground.)
- For multi-ignition models, we will suggest you to get the signal on the first ignition. The best signal source will be in order as D > C > B > A, we will suggest you to check different ways if you have problems to get the RPM signal.

2-2 Installation instructions

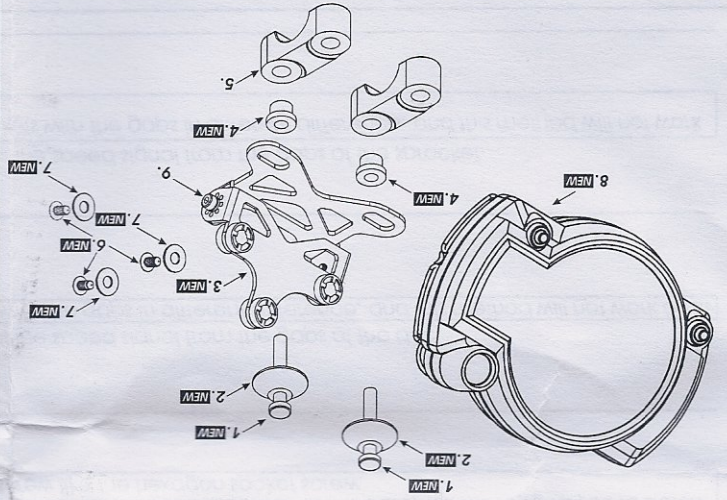

When installing, please follow the process

1. M6 or M8 screw X 2 (Accessory 17, 18)
2. M6 or M8 aluminum screw bush X 2 (Accessory 19, 20)
3. Bracket (Accessory 14)
4. M6 or M8 gasket X 2 (Accessory 21, 22)
5. Handle bar bracket
6. M5 screw X 3 (Accessory 15)
7. M5 gasket X 3 (Accessory 16)
8. Meter (Accessory 1)
9. Meter bracket micro-adjustment screw

- NOTE You could also install it (meter bracket) on the original meter bracket.
- NOTE You could choose the angle first and then use the screw to fix the angle.

NOTE The handle bar bracket screw and screw hole will differ depending on different model. We suggest you to use the additional assembly (item 1, 2, 4) to fit it.